



## Finedust Filter

### Type G91



### Overview

The **G91** filter is designed and tested to extract the smallest particles out of the air. The G91 series contains a fibreglass media pack in different heights (25 mm up to 93 mm) and is available in different types and heights of frames: 1 1/2" / 4".

The filter media is pleated in 'Minipleat shape' with a new application technology of 'Hot Melt Spacers' to achieve the lowest pressure drop results. These many variations always give each application the best and most optimal solution.

### FEATURES

- HEPA efficiencies of E-10 up to H-13
- Finedust efficiencies of M6 up to F9
- Finedust efficiencies of MERV 9 up to MERV 15 ASHRAE 52.1
- Finedust efficiencies of 52.1 and EN 779 or ISO 16890
- High quality micro fibreglass media
- Lowest initial pressure drop
- Rigid cardboard frames
- Frame height of 1" up to 4"
- High quality standards due to Quality Assurance System



### ADVANTAGES:

- High quality standard due to Quality Assurance System
- HEPA filter tested by laser particle counting system
- Highly economical through high final pressure drop
- Usable in two flow directions

**Fine Dust** - HEPA / ULPA

### FILT AIR Ltd.

Fine Dust Filter  
Final Filter for Fan Filter Units  
Final Filter for Clean Rooms  
Final Filter for Channel Installation

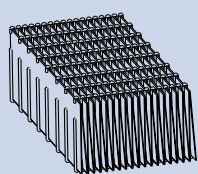
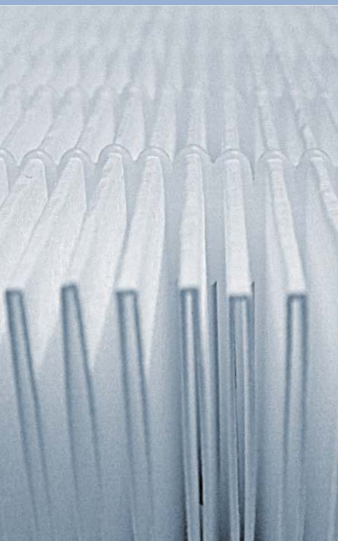

Media Pack 23 mm

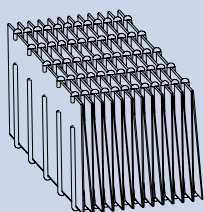

Media Pack 43 mm

**AVAILABLE STANDARDS:**

- High quality standard due to Quality Assurance System
- ISO 9001:2015
- ISO 16890
- EN 779-2012

Model Number	Efficiencies EN 779 /ISO 16890	Nominal Size		Velocity	Initial Pressure
		Inch	mm		
G91-0633-2000	M6/ISO ePM2.5 60%	12" x 12" x 2"	295 x 295 x 47	1.5	150
G91-0636-2000		12" x 24" x 2"	295 x 595 x 47		
G91-0666-2000		24" x 24" x 2"	595 x 595 x 47		
G91-0645-2000		16" x 20" x 2"	395 x 495 x 47		
G91-0733-2000	F7/ISO ePM2.5 70% (ePM1 60%)	12" x 12" x 2"	295 x 295 x 47	1.5	165
G91-0736-2000		12" x 24" x 2"	295 x 595 x 47		
G91-0766-2000		24" x 24" x 2"	595 x 595 x 47		
G91-0745-2000		16" x 20" x 2"	395 x 495 x 47		
G91-0833-2000	F8/ISO ePM1 70%	12" x 12" x 2"	295 x 295 x 47	1.5	180
G91-0836-2000		12" x 24" x 2"	295 x 595 x 47		
G91-0866-2000		24" x 24" x 2"	595 x 595 x 47		
G91-0845-2000		16" x 20" x 2"	395 x 495 x 47		
G91-0633-4000	M6/ISO ePM2.5 60%	12" x 12" x 2"	295 x 295 x 96	1.5	70
G91-0636-4000		12" x 24" x 4"	295 x 595 x 96		
G91-0666-4000		24" x 24" x 4"	595 x 595 x 96		
G91-0645-4000		16" x 20" x 4"	395 x 495 x 96		
G91-0733-4000	F7/ISO ePM2.5 70% (ePM1 60%)	12" x 12" x 2"	295 x 295 x 96	1.5	80
G91-0736-4000		12" x 24" x 4"	295 x 595 x 96		
G91-0766-4000		24" x 24" x 4"	595 x 595 x 96		
G91-0745-4000		16" x 20" x 4"	395 x 495 x 96		
G91-0833-4000	F8/ISO ePM1 70%	12" x 12" x 4"	295 x 295 x 96	1.5	90
G91-0836-4000		12" x 24" x 4"	295 x 595 x 96		
G91-0866-4000		24" x 24" x 4"	595 x 595 x 96		
G91-0845-4000		16" x 20" x 4"	395 x 495 x 96		

**Design and Construction**

The G91 family of filters are made from die cut frame rigid cardboard, which makes them resistant to humidity and provides them with extra durability when assembled. The grid board supports on each side of the filter are built into the frame. These supports are also attached to each pleat in the frame to ensure stability and

consistent spacing of the pleats. The filtration media is glued to the entire frame to prevent any air bypass.

## Technical Data G91

Filter Thickness	Size Code	Nominal Size [inch]	Actual Size [inch]	Nominal Size [mm]
		L x W x H	L x W x H	L x W x H
2"	35	12 x 20 x 2	11.6 x 19.5 x 1.8	305 x 508 x 51
	44	16 x 16 x 2	15.6 x 15.6 x 1.8	406 x 406 x 51
	45	16 x 20 x 2	15.6 x 19.5 x 1.8	406 x 508 x 51
	55	20 x 20 x 2	19.5 x 19.5 x 1.8	508 x 508 x 51
	FD	25 x 16 x 2	24.6 x 15.6 x 1.8	635 x 406 x 51
	FE	25 x 20 x 2	24.6 x 19.5 x 1.8	635 x 508 x 51
	36	12 x 24 x 2	11.6 x 23.4 x 1.8	305 x 610 x 51
	46	16 x 24 x 2	15.6 x 23.4 x 1.8	406 x 610 x 51
	56	20 x 24 x 2	19.5 x 23.4 x 1.8	508 x 610 x 51
	66	24 x 24 x 2	23.4 x 23.4 x 1.8	610 x 610 x 51
4"	35	12 x 20 x 4	11.6 x 19.5 x 3.74	305 x 508 x 102
	44	16 x 16 x 4	15.6 x 15.6 x 3.74	406 x 406 x 102
	45	16 x 20 x 4	15.6 x 19.5 x 3.74	406 x 508 x 102
	55	20 x 20 x 4	19.5 x 19.5 x 3.74	508 x 508 x 102
	FD	25 x 16 x 4	24.6 x 15.6 x 3.74	635 x 406 x 102
	FE	25 x 20 x 4	24.6 x 19.5 x 3.74	635 x 508 x 102
	36	12 x 24 x 4	11.6 x 23.4 x 3.74	305 x 610 x 102
	46	16 x 24 x 4	15.6 x 23.4 x 3.74	406 x 610 x 102
	56	20 x 24 x 4	19.5 x 23.4 x 3.74	508 x 610 x 102
	66	24 x 24 x 4	23.4 x 23.4 x 3.74	610 x 610 x 102

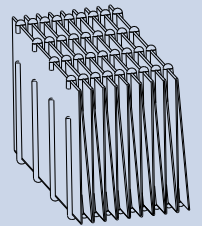
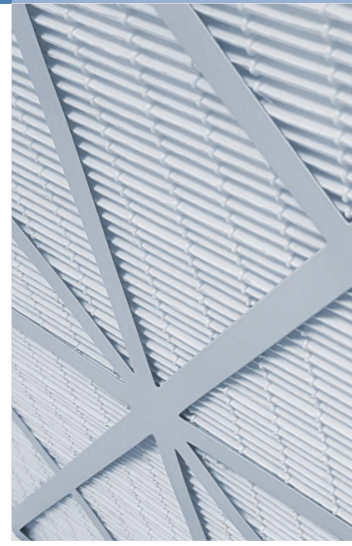

Media Pack 93 mm

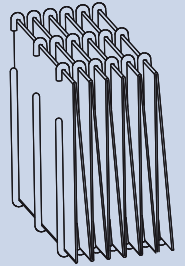

Media Pack 140 mm

## Technical Drawing:

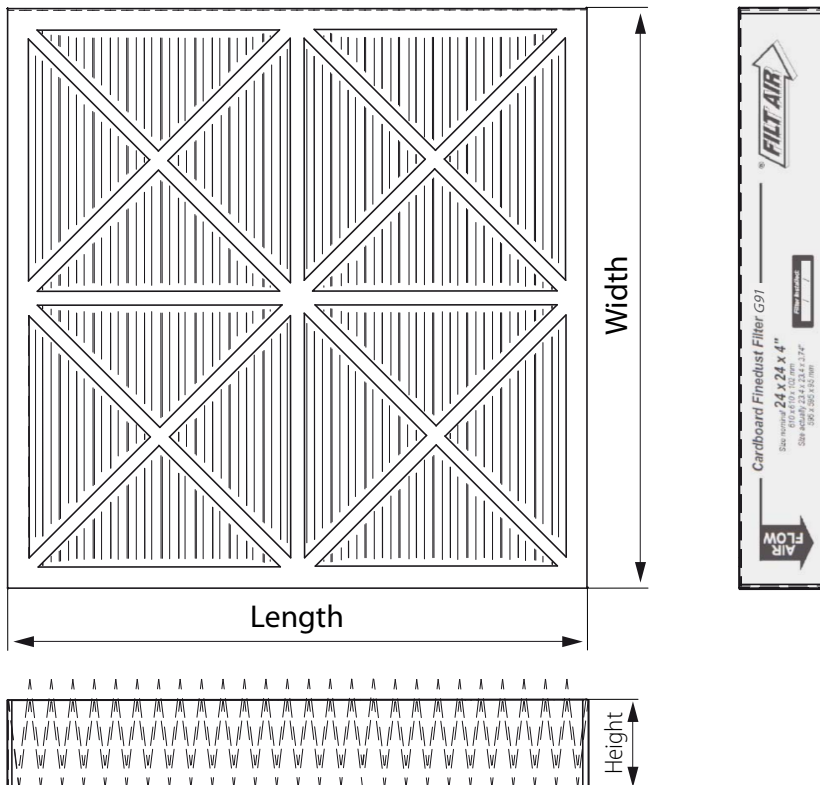

## Order Numbers

Order no.	G91	A	B	-	C	D	E	F
Example	G91	06	66	-	2	0	0	0

Efficiency	A	Size LxW (actual)	B	Frame Height (actual)	C	Frame	D	Free	E	Free	F
M6	06	12 X 20" (295 X 495 mm)	35	1" (25 mm)	1	Carton	0	Free	0	Free	0
F7	07	12 X 24" (295 X 595 mm)	36	2" (45 mm)	2						
F8	08	16 x 16" (395 x 395 mm)	44	4" (95 mm)	4						
F9	09	16 x 20" (395 x 495 mm)	45								
Other Efficiencies available upon request		16 x 25" (395 x 625 mm)	FD								
		20 x 20" (495 x 495 mm)	55								
		20 x 24" (495 x 595 mm)	56								
		20 x 25" (495 x 625 mm)	FE								
		24 x 24" (595 x 595 mm)	66								
		Other dimensions available upon request									

Specifications are subject to change without prior notice

## HEPA & ULPA Filters for Industrial Clean Rooms

FILT AIR Ltd. specializes in the use of advanced technologies to implement a purified air supply for high-tech industry clean rooms, the microelectronics business sectors, and pharmaceutical industries. FILT AIR Ltd. has a broad range of client groups, such as hospitals, industrial plants, commercial buildings, and companies requiring clean air inside gas turbines.

FILT AIR's range of products is designed and produced in order to achieve the highest possible quality and offers safety and reliability with optimum prices and product availability. Since 2001, FILT AIR Ltd. has been registered and certified for Quality Management according to ISO 9001 (Registration No: IQNet: IL-24203).

### FILT AIR Ltd.

Member of the Beth-El Group

Main Office: P.O. Box 166  
 Zikhron Yaaqov, 3095101, Israel  
 Tel: + 972-4-610 7777  
 Fax: + 972-4-635 0396  
[info@filt-air.com](mailto:info@filt-air.com)  
[www.filt-air.com](http://www.filt-air.com)